

Nonmetallic Sheathed Cable Connectors

NEC:
Listed for Ordinary Locations

NEC/CEC:
Listed for Ordinary Locations

Nonmetallic Sheathed Cable ^① Connector With Cam Lock

Applications

- To ground and secure nonmetallic sheathed cable to boxes and enclosures.

Features

- Positive-stop locking action.
- Used with 14-2, 12-2 and 10-2 (with or without ground).

Standard Material

- Thermoplastic

NEC/CEC Certifications and Compliances

- UL Standard: 514B
- UL Listed: E23237
- NEMA: FB-1

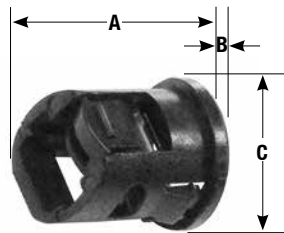

Trade Size (Inches)	Dimensions in Millimeters (Inches)			Weight per 100 kg (lb)	Catalog Number
	A	B	C		
1/2	27.7 (1.09)	3.3 (0.13)	25.4 (1.00)	0.59 (1.30)	A-1 ^②

Nonmetallic Sheathed Cable and Service Entrance Cable ^① Connectors

Applications

- To secure service entrance cable and nonmetallic sheathed to boxes and enclosures.

Features

- Furnished with locknut.
- Male hub threads — NPS.

Standard Material/Finish

- Malleable iron/zinc electroplated

NEC/CEC Certifications and Compliances

- UL Standard: 514B
- UL Listed: E23237
- CSA Standard: C22.2 No. 18.3
- CSA Certified: 065178
- NEMA: FB-1

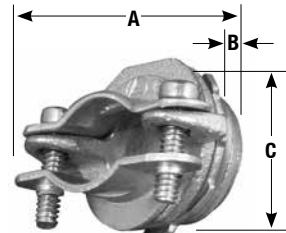

15233

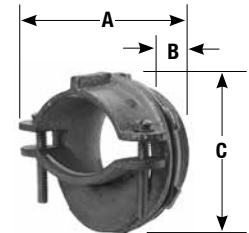

15237

Trade Size (Inches)	Cable Opening in Millimeters (Inches)		Dimensions in Millimeters (Inches)			Weight per 100 kg (lb)	Catalog Number
	Max.	Min.	A	B	C		
3/4	18.8 (0.74)	11.2 (0.44)	16.8 (0.66)	11.2 (0.44)	46.0 (1.81)	6.53 (14.40)	15233
1	24.6 (0.97)	12.7 (0.50)	16.8 (0.66)	14.2 (0.56)	51.6 (2.03)	9.53 (21.00)	15234
1-1/4	33.3 (1.31)	20.6 (0.81)	16.8 (0.66)	14.2 (0.56)	60.5 (2.38)	13.65 (30.10)	15235
1-1/2	40.4 (1.59)	20.6 (0.81)	20.6 (0.81)	19.1 (0.75)	66.8 (2.63)	24.04 (53.00)	15236
2	50.8 (2.00)	25.4 (1.00)	23.9 (0.94)	19.1 (0.75)	82.6 (3.25)	36.29 (80.00)	15237

^① Select connectors by physical dimensions of cable as dimensions may vary between manufacturers.

^② Not CSA certified.